

DUBLIN MIXER

Deck mount mixer
Installation guidelines
Style # 17206121

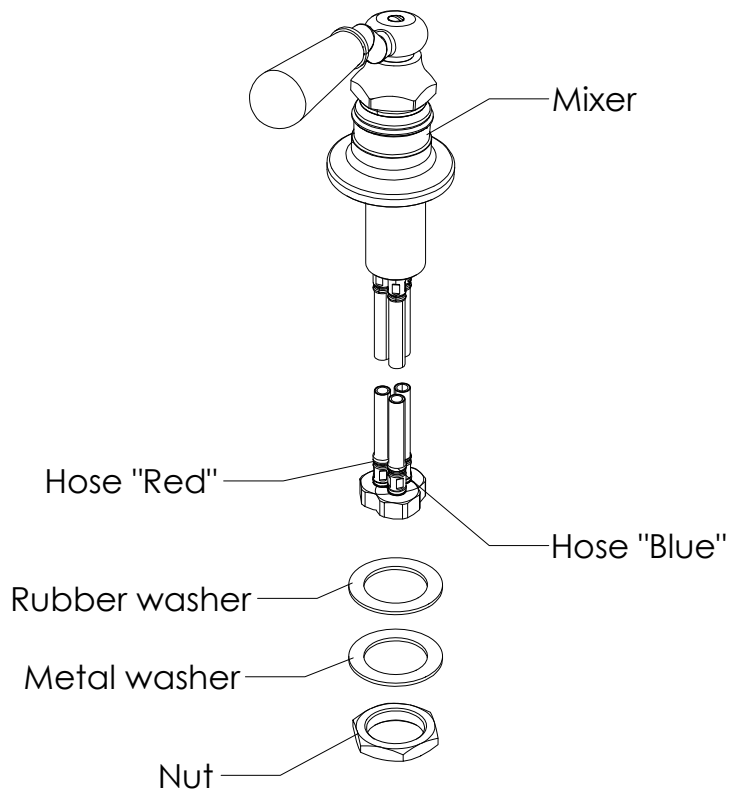

- Place the mixer through the mounting hole.
 - Place the rubber washer, metal washer and nut on body mixer and securely tighten the nut to secure the mixer.
 - Connect the hoses on the water supply.
- NOTE: The supply hoses are marked with colored zip ties to identify their function, red for incoming hot supply water and blue for incoming cold supply water.
- The third is flexible mixed water supply and will be connected to the element of your choice (spout, hand shower).