

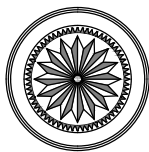

FLEX HOSE LENGTH = 60"





XL-PEARL

Deck Mount Tub Spout - Regalia - $\frac{3}{4}$ " NPT

Bec sure gorge pout bain - $\frac{3}{4}$ " NPT

Style # 6206204

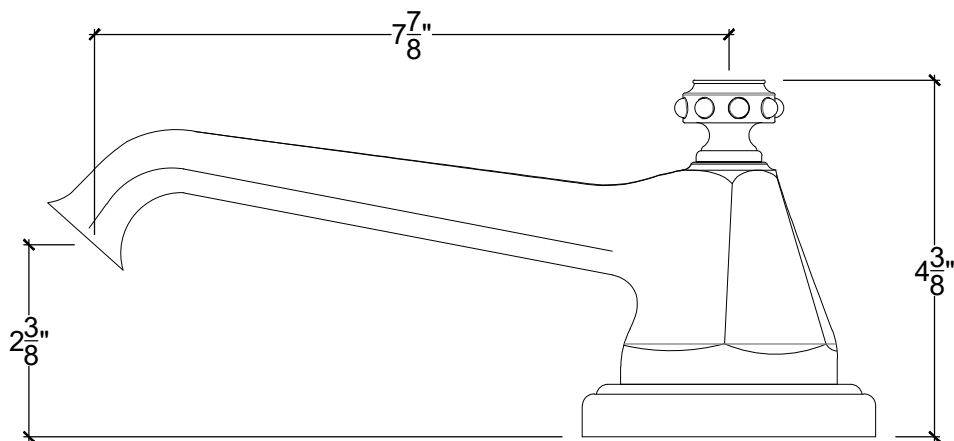
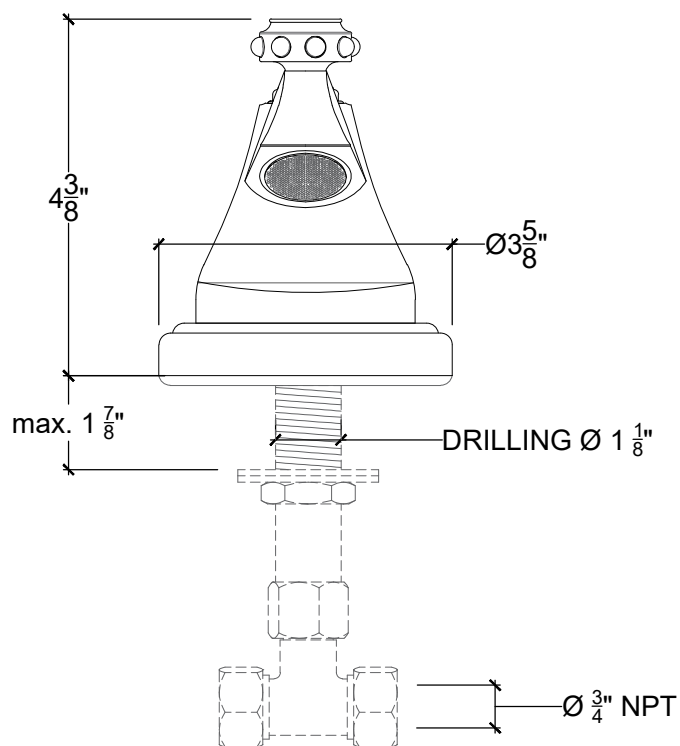

Copyright © Compass 2010 www.compassstone.com



COMPAS[™]

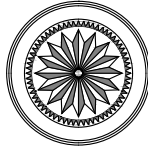

XL - PEARL

Deck Mounted 3/4" handle
Style # 06206725

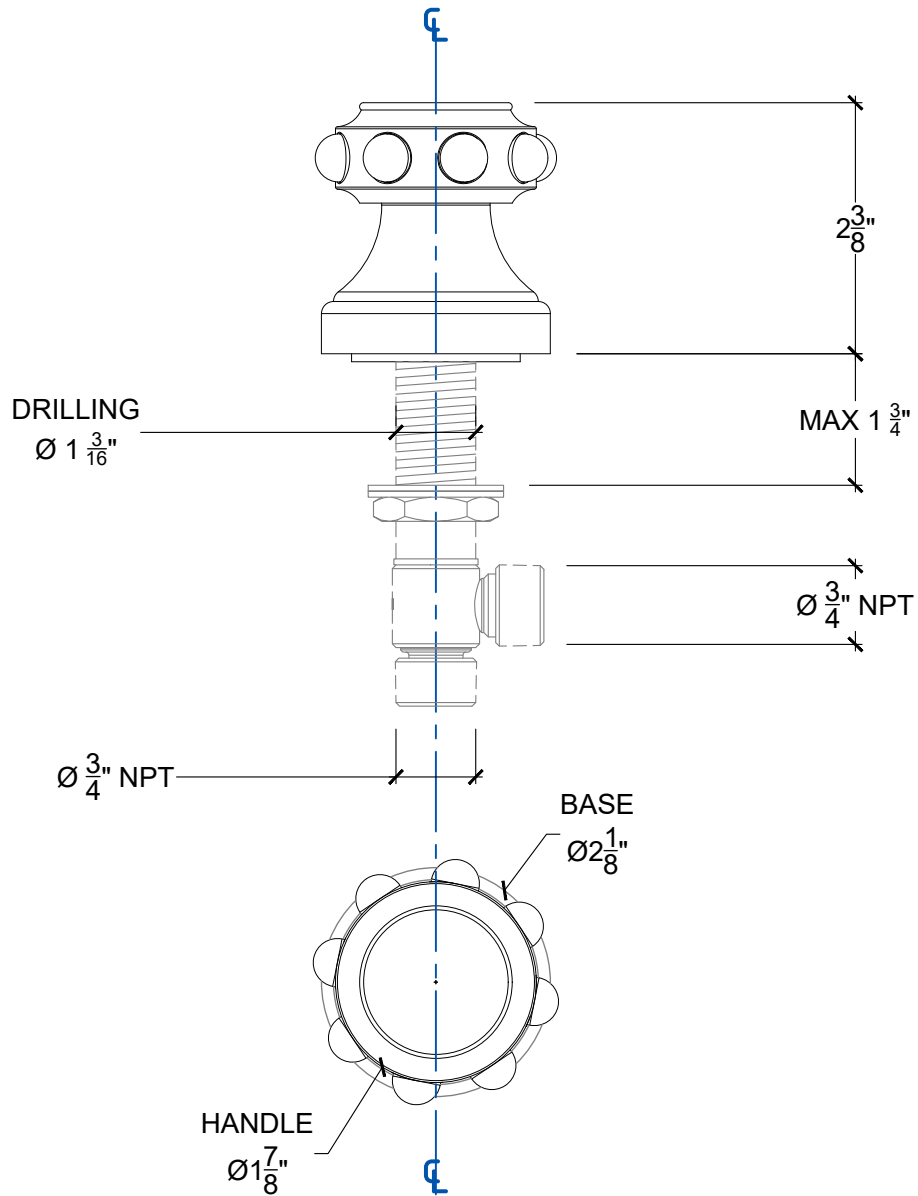

Copyright © 2010 Compass 2010 www.compassstone.com

 COMPAS™

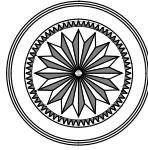

XL - PEARL DM DIVERTER

Deck Mounted XL-Pearl Diverter
Inverseur Automatique sur gorge

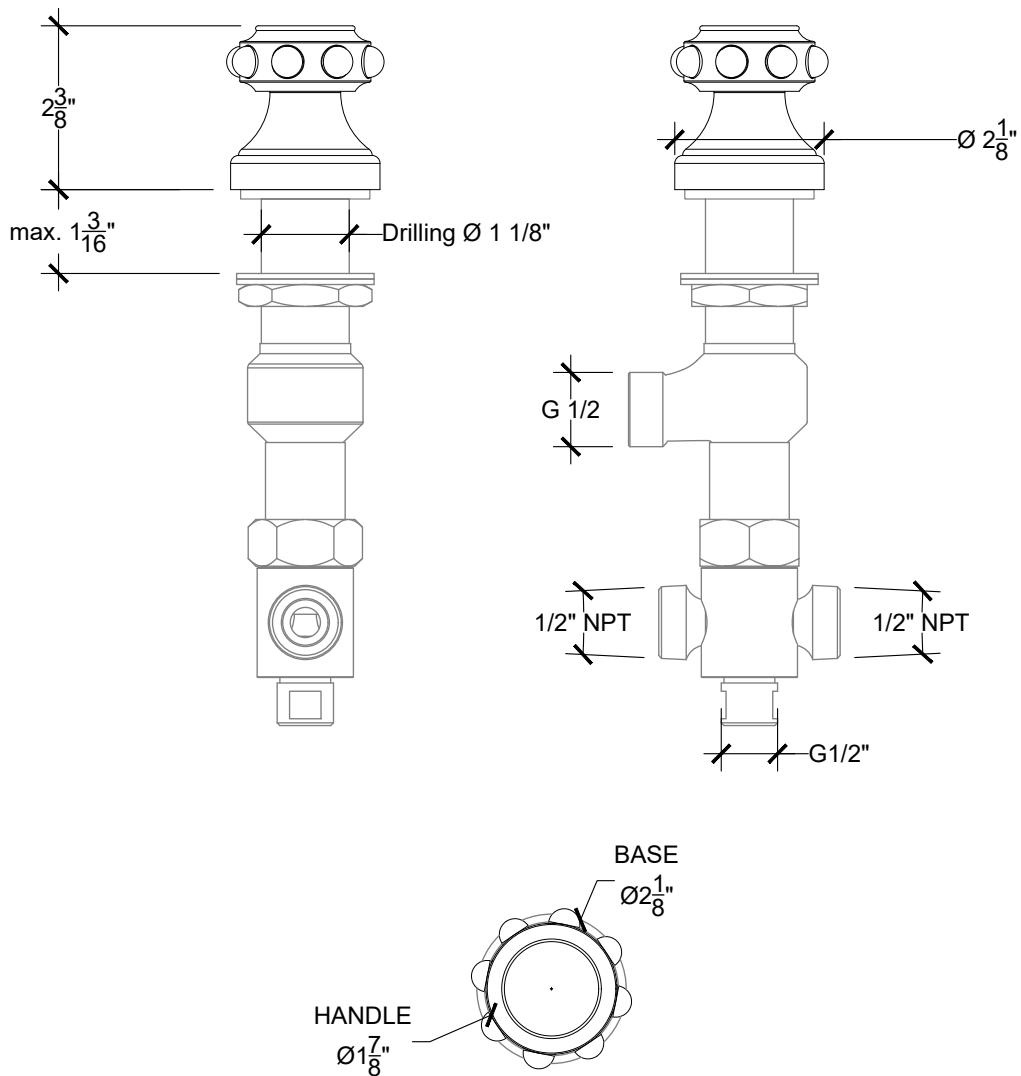

Copyright © Compass 2010 www.compassstone.com

 COMPAS™

REVISED 02-10-20

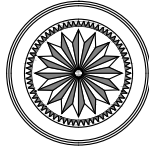

NOVO

Deck Mounted Novo Hand Held - XL-Pearl Base - $\frac{1}{2}$ " NPT

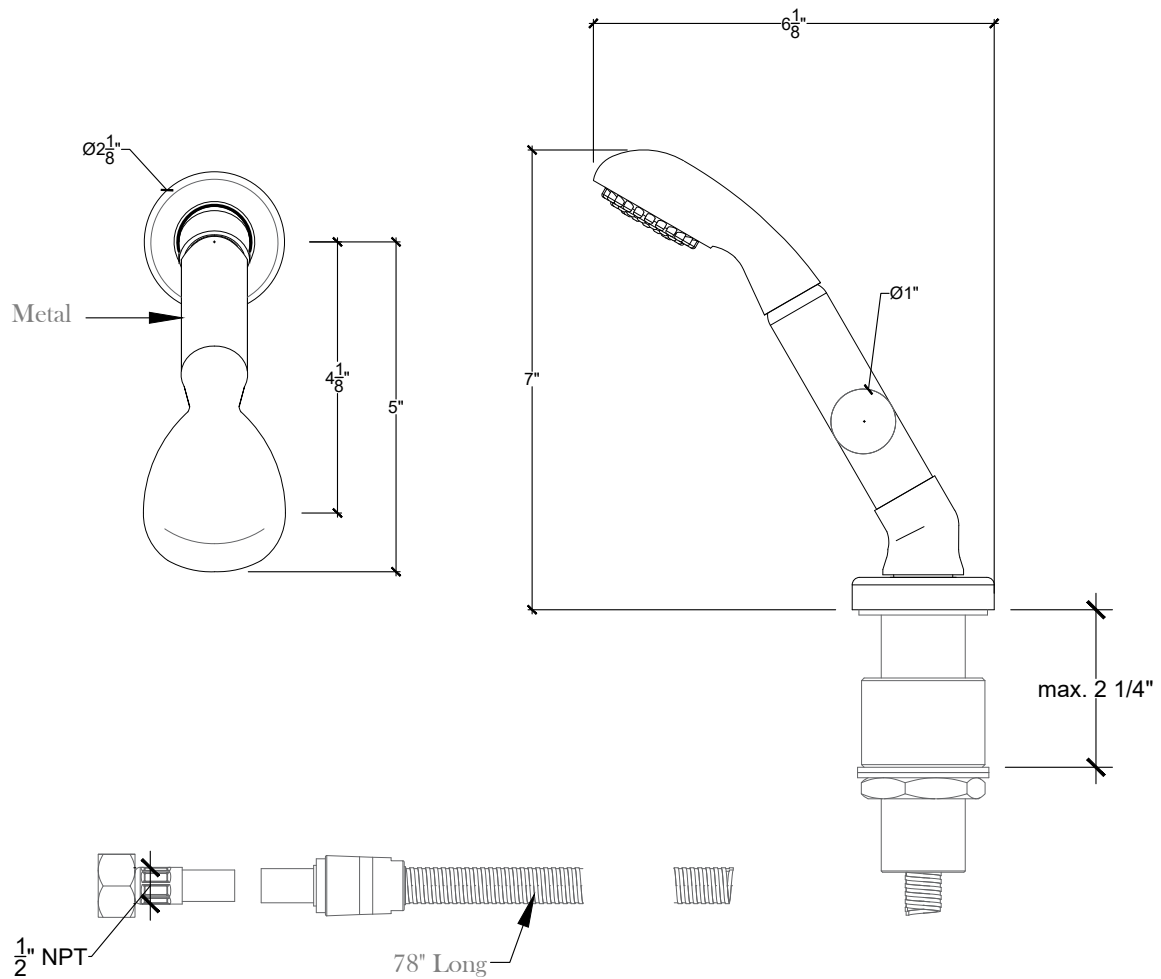

* To be Used with a Diverter

 COMPAS™

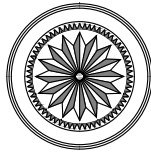

XL-PEARL

Wall Mounted Tub Filler with XL-Pearl Handles and Hand Held - 3/4" NPT
Melangeur Bain / Deauchette mural - 3/4" NPT
Style # 06206209

FLEX HOSE LENGTH = 60"

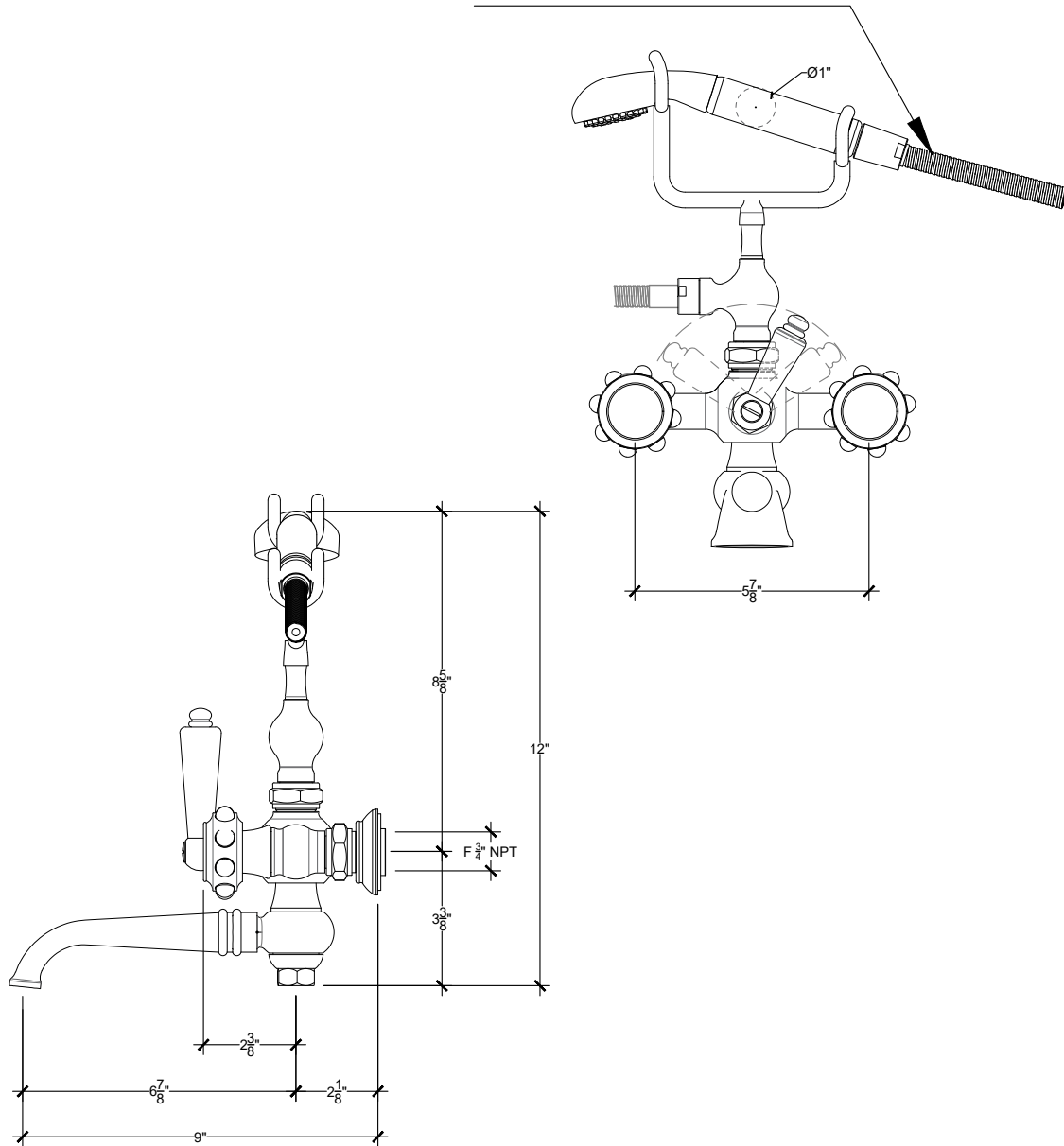

Copyright © Compass 2010 www.compassstone.com



COMPAS™

REVISED 02/10/20

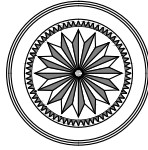

XL - PEARL

Wall Mounted XL-Pearl Handles for Tub / SHower - 3/4" NPT
Style # 06206735

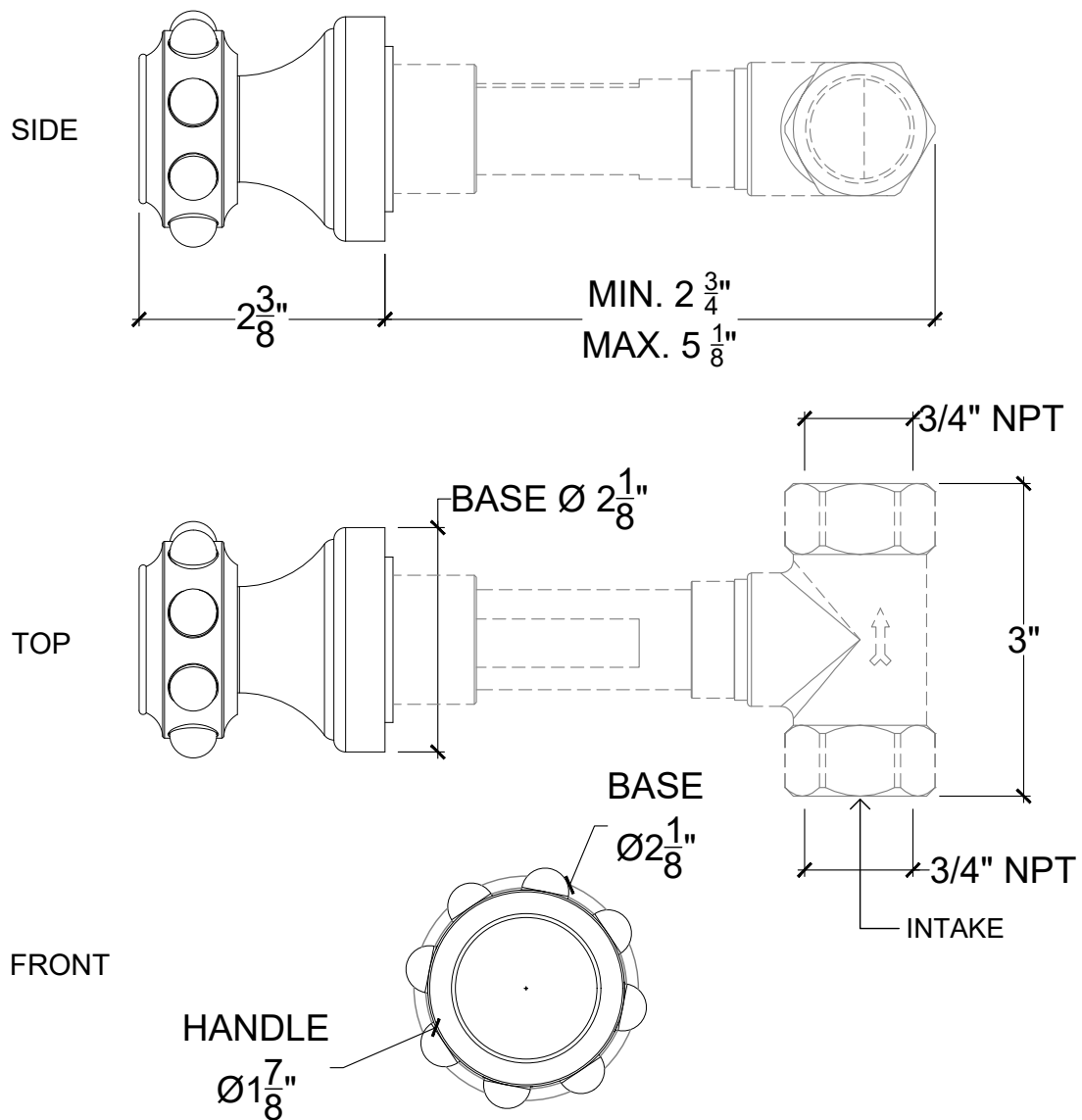

Copyright Compass 2010 www.compassstone.com

 COMPAS™

REVISED 1-28-20

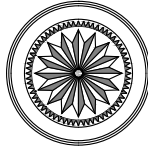

XL-PEARL

Wall mounted XL-Pearl 2-Way Diverter - $\frac{3}{4}$ " NPT
Facade D'inverseur - $\frac{3}{4}$ " NPT
Style # 6206602

SIDE VIEW

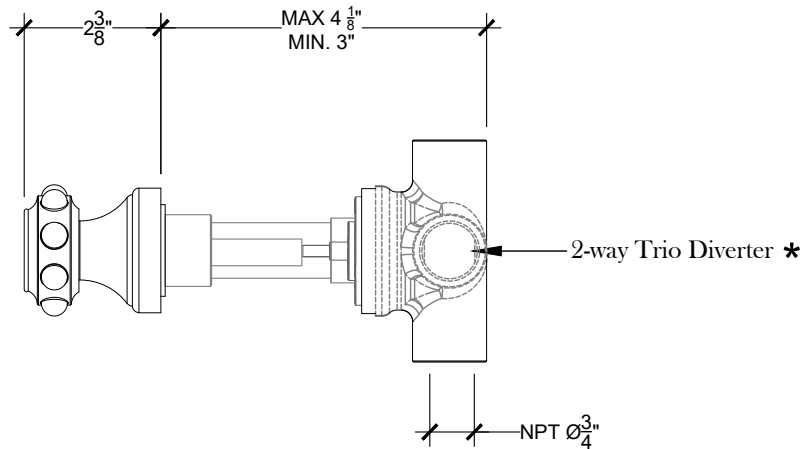

TOP VIEW

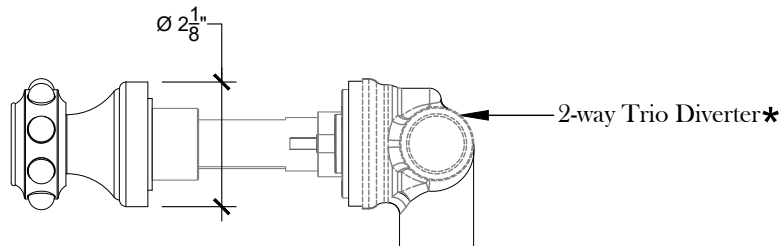

FRONT VIEW

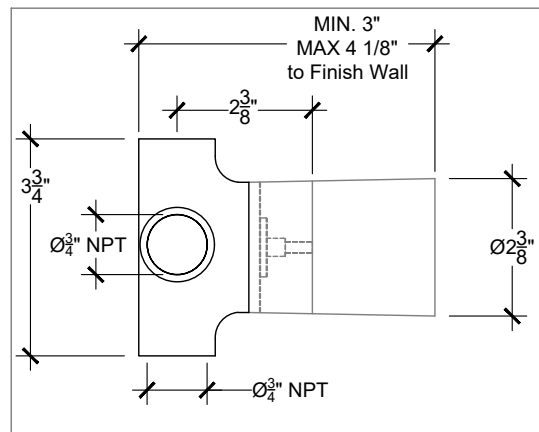
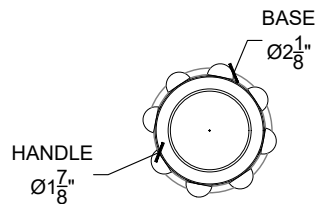

* 2-Way Diverter: 15984181

Copyright © Compass 2010 www.compassstone.com

 COMPAS™

REVISED 01-28-20

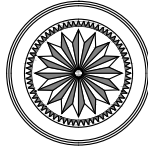

NOVO

Wall Mounted Novo Hand Held on Cradle
Ensemble Douchette sur Crochet
Style # 7406333

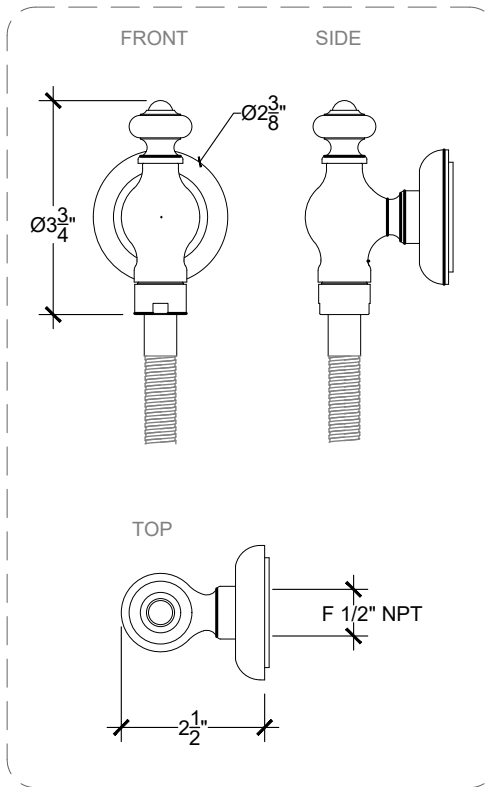
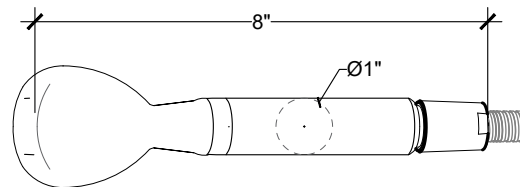
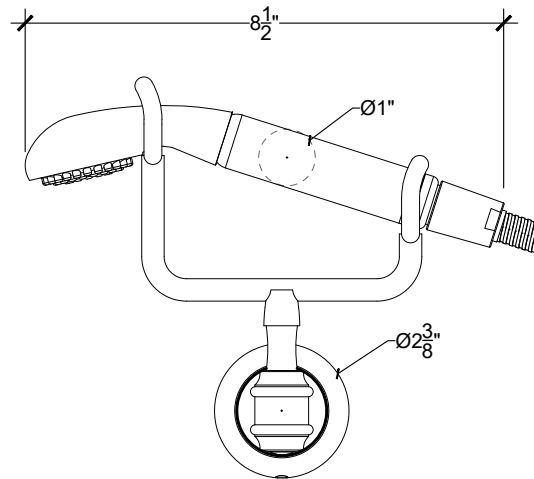
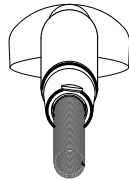

Copyright © Compas 2010 www.compasstone.com

*Requires a Thermostatic Mixer



COMPAS™

Product Support +1 310 854 3023

02-10-2020

Technical Drawings are subject to change at Compas' discretion.